

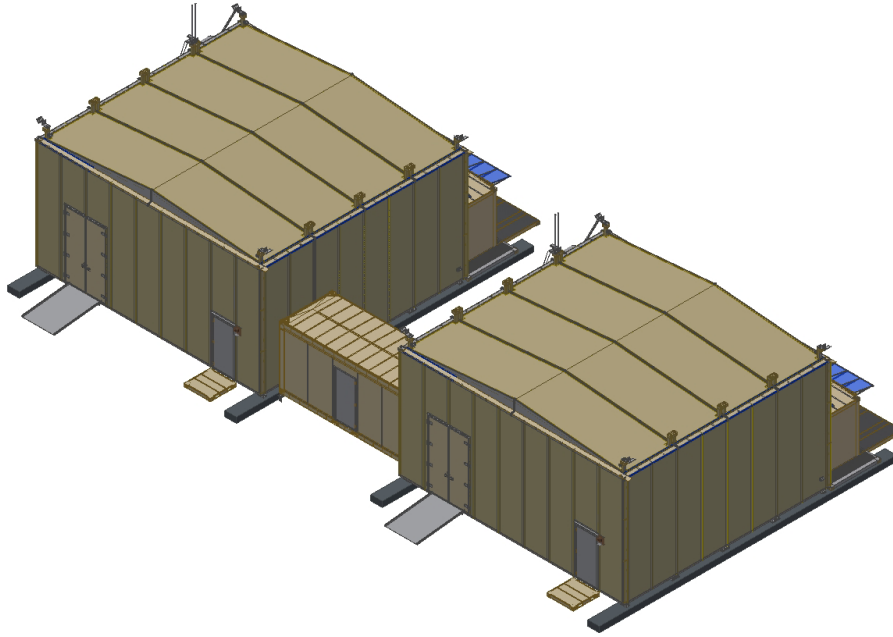

Relocatable Simulation Shelter (RSS) - Security Hallway

Hallway to connect Relocatable Simulation Shelters. Doorways on each end with locking hardware to allow only secure access between the two shelters



Standard Features

- Steel Frame and Insulated, Smooth Wall Panels
- 20'x 9.5' x 8' Hallway
- Emergency Egress Door on One Side
- (2) RSS Wall Panels with Doorways to Connect Shelters
- FF-L-2740B approved locks
- (2) Butting Kits Connect Hallway to RSS and Create a Weather-tight Seal
- (4) 200mph Rated Deck Mount Plates & Anchor Kits
- (2) LED Lights with Occupancy Sensor

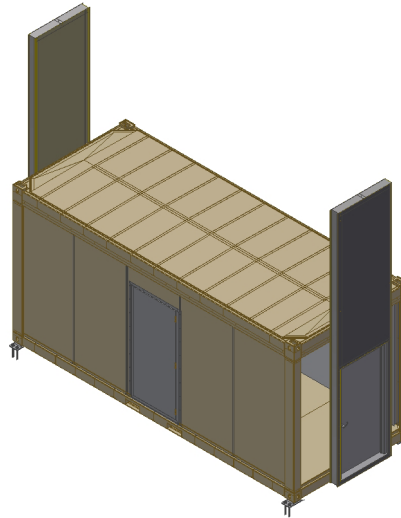

Works in conjunction with Sea Box Part Nos. SB3897.RSS.4S, SB3897.RSS.6S, SB3897.RSS.8S, SB3897.RSS.12S

	LENGTH		HEIGHT		WIDTH	
	Exterior	Interior	Exterior	Interior	Exterior	Interior
Ft in	19' 10.5"	19' 10.5"	9' 6"	8' 1.125"	8'	7' 1.625"
Metric	6,058	6,058	2,896	2,467	2,438	2,175

SB3897.RSS.SHALL
Relocatable Simulation Shelter (RSS) - Security Hallway

091416-R00

ISO 9001



CERTIFIED QUALITY
MANAGEMENT SYSTEM