

SEA BOX

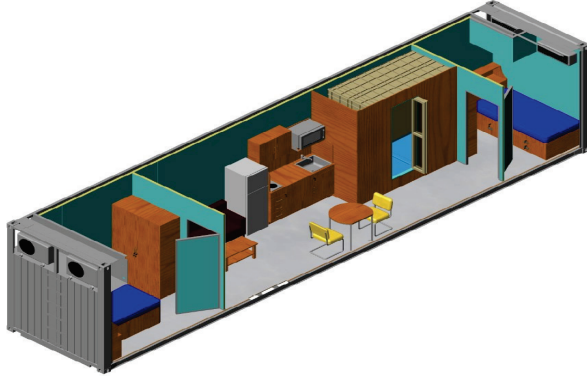

STANDARD FEATURES:

- 2 Bedroom Accommodation Unit
- Security screens and shutters
- Strong, secure, durable low maintenance units
- Corten Steel frame construction
- Stackable and interlockable
- Easy to transport by Road, Rail or Sea
- Minimal on-site setup and preparation work

OPTIONAL FEATURES:

- Powder coated Steel furniture and Laminated furniture
- Wide variety of furniture and fitting designs and accessories
- Electrical standards for various locations around the world

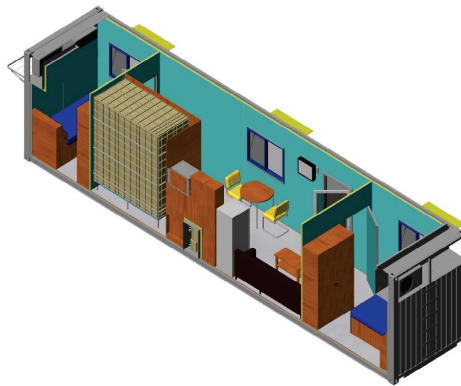
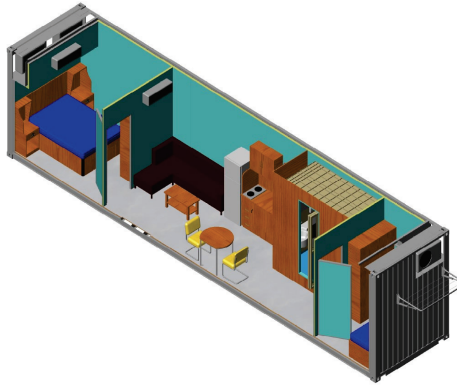

ALL NEW CONTAINERS ARE MANUFACTURED TO THE LATEST ISO STANDARDS

CHU	Length		Height		Width		Door Opening	
	Ext.	Int.	Ext.	Int.	Ext.	Int.	Height	Width
Ft. / In.	40' 0"	39' 5 3/4"	9' 6"	8' 10 1/16"	8' 0"	7' 8 1/2"	N/A	N/A
Metric	12,192	12,033	2,896	2,694	2,438	2,350	N/A	N/A

CHU	Tare Weight	Payload	Gross Weight	Cubic Capacity
Lbs.	8,530	58,670	67,200	2,690 Cu. Ft.
Kg.	3,870	26,610	30,480	76.2 Cu. M.

SB461.9.CHU-2M
 Containerized Housing Unit - 40' 2 MAN Type 2



SEA BOX, INC.
 1 Sea Box Drive
 East Riverton, NJ 08077
 Tel: (856) 303-1101
 Fax: (856) 303-1501
 Email: sales@seabox.com
www.seabox.com

102810-R01

ALL DIMENSIONS AND WEIGHTS ARE NOMINAL AND SUBJECT TO MINOR VARIATIONS THAT MAY OCCUR DURING THE MANUFACTURING PROCESS