

# Sea Box, Inc.

## CORPORATE OFFICE

802 Industrial Hwy.  
 East Riverton, NJ 08077-1910  
 Tel: (856) 303-1101  
 Fax: (856) 303-1501  
[www.seabox.com](http://www.seabox.com)  
 e-mail: [sales@seabox.com](mailto:sales@seabox.com)

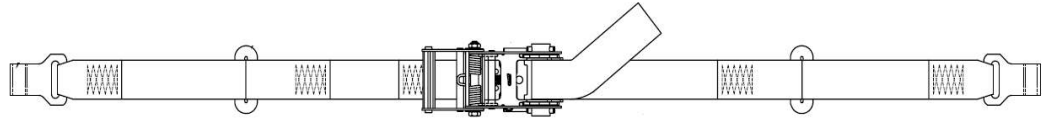

## RATCHET AND WEB STRAP ASSEMBLY

**3,333 lbs. Working Load Limit / 4 lbs Tare Weight**

**This item can be used to secure cargo in ISO Containers**

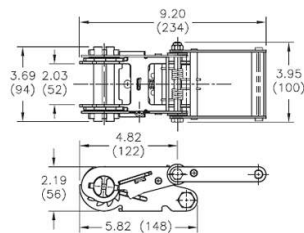

### LONG, WIDE HANDLE TORQUE LIMITING RATCHET

Breaking Strength: 11,000 lbs. / 4,990 kg.

Working Load Limit: 3,666 lbs. / 1,663 kg.

Weight: 2.77 lbs. / 1.26 kg.

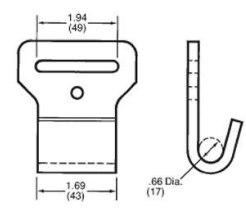

### 2-INCH FLAT HOOK

Breaking Strength: 5,000 lbs. / 2,272 kg.

Working Load Limit: 3,333 lbs. / 1,512 kg.

Weight: .40 lb. / .18 kg.



### 2-INCH WEB STRAP - Polyester, Latex Treated

Width: 2.00 in. / 50 mm.

Breaking Strength Capacity: 12,000 lbs. / 5,454 kg.

Working Load Limit: 4,000 lbs. / 1,818 kg.

Standard Color: Yellow



### WEB STRAP MOUNTING OPTIONS:

- A. Track Fitting with "D" Ring
- B. Wrap around Shoring & Decking Beam
- C. Wall "Belt Buckle" Tie Down
- D. Floor "D" Rings



**PART # SB3400**